

BNS33-02Z-ST-2187



- Long life
- no mechanical wear
- 88 mm x 25 mm x 13 mm
- Insensitive to soiling
- Thermoplastic enclosure
- Connector M8 x 1, 4-pole
- Individual contact outlet
- Concealed mounting possible
- Insensitive to transverse misalignment

Data

Ordering data

Product type description	BNS 33-02ZST-2187
Article number (order number)	101173053
EAN (European Article Number)	4030661301990
eCI@ss number, Version 9.0	27-27-24-02

Approval - Standards

Certificates	TÜV EAC
--------------	------------

General data

Product name	BNS 33
Standards	IEC 60947-5-3 BG-GS-ET-14
Installation conditions (mechanical)	not flush
Enclosure material	Glass-fibre, reinforced thermoplastic
Gross weight	35 g

General data - Features

Prerequisite evaluation unit	Yes
Number of openers	2

Safety appraisal

Standards	ISO 13849-1
-----------	-------------

Mission Time 20 Year(s)

Safety appraisal - Safety outputs

B10d Normally-closed contact (NC) 25,000,000 Operations

Mechanical data

Active area lateral
Actuating element Magnet
Ensured switch distance "ON" S_{ao} 5 mm
8 mm
Ensured switch distance "OFF" S_{ar} 15 mm
18 mm
Repeat accuracy R $\leq 0.1 \times S_{ao}$
Direction of motion Head-on to the active surface

Mechanical data - Connection technique

Terminal Connector Connector M8

Mechanical data - Dimensions

Height of sensor 25 mm
Length of sensor 13 mm
Width of sensor 88 mm

Ambient conditions

Protection class IP67
Ambient temperature, minimum -25 °C
Ambient temperature, maximum +70 °C
Storage and transport temperature, minimum -25 °C
Storage and transport temperature, maximum +70 °C
Resistance to vibrations to EN 60068-2-6 10 ... 55 Hz, amplitude 1 mm
Resistance to shock 30 g / 11 ms

Electrical data

Voltage type AC (alternating current)
DC (direct current)
Switching voltage, maximum 60 VAC
Switching current, maximum 0.25 A
Switching capacity, maximum 5 W
Switching frequency, maximum 5 Hz

Electrical data - Digital Output

Versions Miscellaneous, Reed contacts

Pictures

Product picture (catalogue individual photo)



ID: kbns3f21

| 129,8 kB | .jpg | 232.833 x 105.481 mm - 660 x 299
Pixel - 72 dpi
| 23,0 kB | .png | 74.083 x 33.514 mm - 210 x 95 Pixel
- 72 dpi

Dimensional drawing basic component

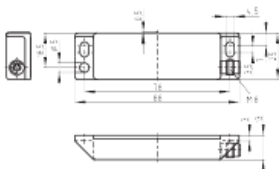

ID: 1bns3g06

| 80,9 kB | .jpg | 352.778 x 248.003 mm - 1000 x 703
Pixel - 72 dpi
| 93,7 kB | .cdr |
| 3,9 kB | .png | 74.083 x 52.211 mm - 210 x 148 Pixel
- 72 dpi

Diagram

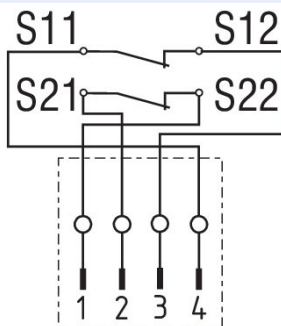

ID: kbns3k22

| 19,2 kB | .cdr |
| 126,8 kB | .jpg | 352.778 x 404.283 mm - 1000 x
1146 Pixel - 72 dpi

Characteristic curve

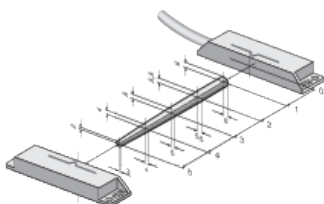

ID: kbns3a01

| 124,5 kB | .jpg | 352.778 x 216.253 mm - 1000 x 613
Pixel - 72 dpi
| 13,1 kB | .png | 74.083 x 45.508 mm - 210 x 129
Pixel - 72 dpi
| 96,3 kB | .cdr |

Contact arrangement

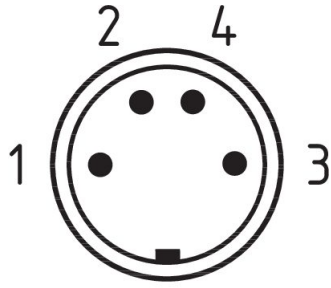

ID: km8--k4b

| 17,0 kB | .cdr |

K.A. Schmersal GmbH & Co. KG, Möddinghofe 30, D-42279 Wuppertal

The details and data referred to have been carefully checked. Images may diverge from original. Further technical data can be found in the manual. Technical amendments and errors possible.

Generated on 26.11.2020 16:28:56